

## 6 街区面積計算書

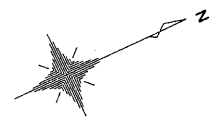

S = 1 : 500

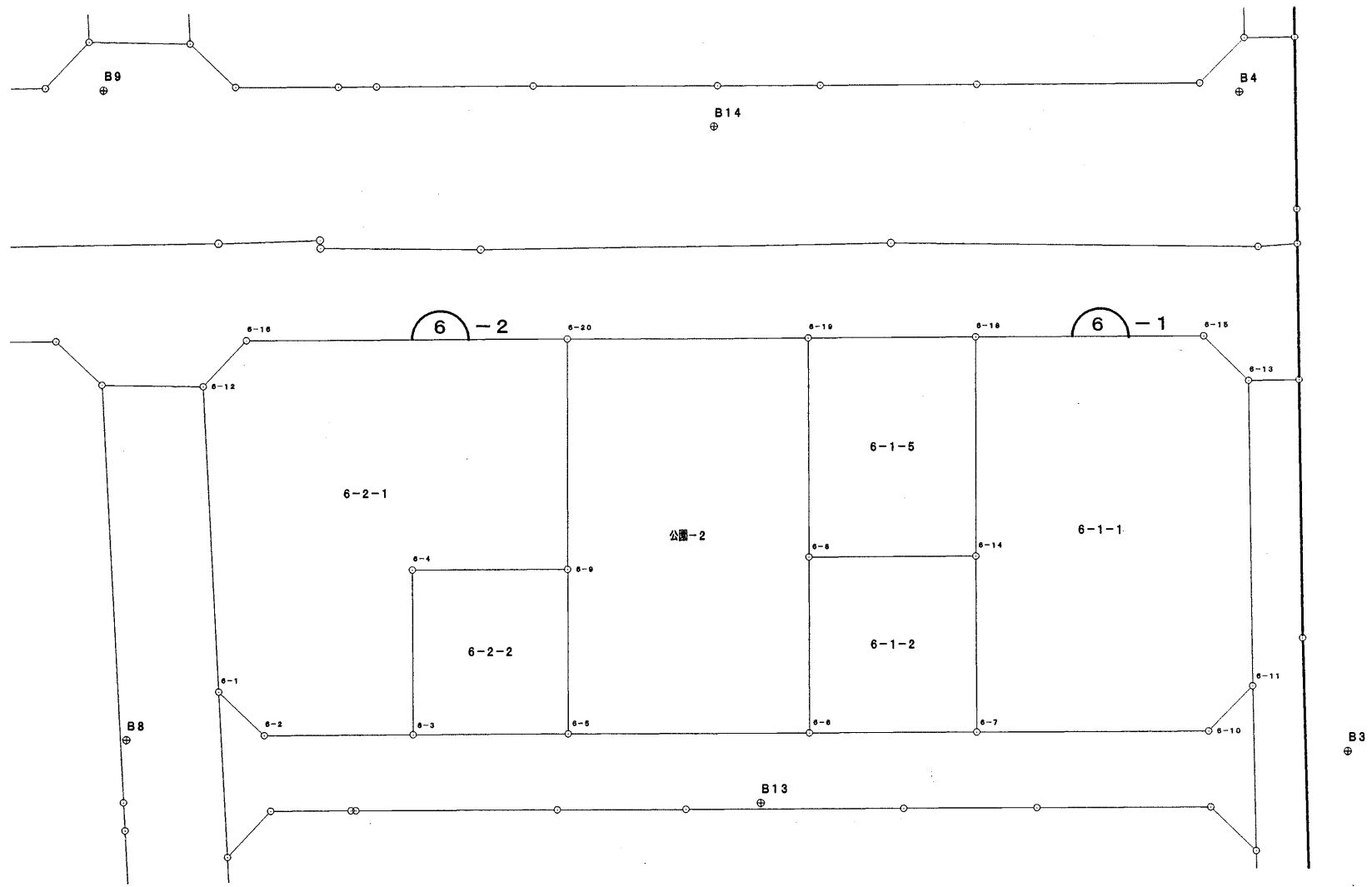

面積計算書

地番: 6-1-1

| 測点   | X           | Y          | DX      | DY      | 距離      | 方向角       | 夾角         | 倍横距     | 倍面積                        |
|------|-------------|------------|---------|---------|---------|-----------|------------|---------|----------------------------|
| 6-7  | -194565.686 | -43280.090 | 5.837   | -12.610 | 13.895  | 294-50-20 | 269-55-49  | -12.610 | -73.604570                 |
| 6-14 | -194559.849 | -43292.700 | 7.324   | -15.732 | 17.353  | 294-57-51 | 180-07-31  | -40.952 | -299.932448                |
| 6-18 | -194552.525 | -43308.432 | 16.434  | 7.626   | 18.117  | 24-53-35  | 269-55-44  | -49.058 | -806.219172                |
| 6-15 | -194536.091 | -43300.806 | 1.730   | 4.696   | 5.005   | 69-46-35  | 224-53-00  | -36.736 | -63.553280                 |
| 6-13 | -194534.361 | -43296.110 | -9.970  | 22.028  | 24.179  | 114-21-06 | 224-34-31  | -10.012 | 99.819640                  |
| 6-11 | -194544.331 | -43274.082 | -4.670  | 1.740   | 4.984   | 159-33-54 | 225-12-48  | 13.756  | -64.240520                 |
| 6-10 | -194549.001 | -43272.342 | -16.685 | -7.748  | 18.396  | 204-54-31 | 225-20-37  | 7.748   | -129.275380                |
| 合計   |             |            |         |         | 101.929 |           | 1620-00-00 | 面積      | -1337.005730<br>668.502865 |

面積計算書

地番: 6-1-2

| 測点   | X           | Y          | DX      | DY      | 距離     | 方向角       | 夾角         | 倍横距     | 倍面積                       |
|------|-------------|------------|---------|---------|--------|-----------|------------|---------|---------------------------|
| 6-6  | -194577.750 | -43285.688 | 5.859   | -12.603 | 13.898 | 294-56-00 | 270-02-27  | -12.603 | -73.840977                |
| 6-8  | -194571.891 | -43298.291 | 12.042  | 5.591   | 13.277 | 24-54-18  | 269-58-18  | -19.615 | -236.203830               |
| 6-14 | -194559.849 | -43292.700 | -5.837  | 12.610  | 13.895 | 114-50-20 | 269-56-02  | -1.414  | 8.253518                  |
| 6-7  | -194565.686 | -43280.090 | -12.064 | -5.598  | 13.300 | 204-53-33 | 270-03-13  | 5.598   | -67.534272                |
| 合計   |             |            |         |         | 54.370 |           | 1080-00-00 | 面積      | -369.325561<br>184.662780 |

面積計算書

地番: 6-1-5

| 測点   | X           | Y          | DX      | DY      | 距離     | 方向角       | 夾角         | 倍横距     | 倍面積                       |
|------|-------------|------------|---------|---------|--------|-----------|------------|---------|---------------------------|
| 6-8  | -194571.891 | -43298.291 | 7.311   | -15.734 | 17.350 | 294-55-21 | 270-01-03  | -15.734 | -115.031274               |
| 6-19 | -194564.580 | -43314.025 | 12.055  | 5.593   | 13.289 | 24-53-21  | 269-58-00  | -25.875 | -311.923125               |
| 6-18 | -194552.525 | -43308.432 | -7.324  | 15.732  | 17.353 | 114-57-51 | 270-04-30  | -4.550  | 33.324200                 |
| 6-14 | -194559.849 | -43292.700 | -12.042 | -5.591  | 13.277 | 204-54-18 | 269-56-27  | 5.591   | -67.326822                |
| 合計   |             |            |         |         | 61.269 |           | 1080-00-00 | 面積      | -460.957021<br>230.478510 |

面積計算書

地番: 6-2-1

| 測点   | X           | Y          | DX      | DY      | 距離      | 方向角       | 夾角         | 倍横距     | 倍面積                        |
|------|-------------|------------|---------|---------|---------|-----------|------------|---------|----------------------------|
| 6-4  | -194600.905 | -43310.764 | -5.483  | 11.796  | 13.008  | 114-55-48 | 89-59-45   | 11.796  | -64.677468                 |
| 6-3  | -194606.388 | -43298.968 | -10.738 | -4.991  | 11.841  | 204-55-44 | 269-59-56  | 18.601  | -199.737538                |
| 6-2  | -194617.126 | -43303.959 | -1.824  | -4.644  | 4.989   | 248-33-25 | 223-37-41  | 8.966   | -16.353984                 |
| 6-1  | -194618.950 | -43308.603 | 9.150   | -22.396 | 24.193  | 292-13-22 | 223-39-57  | -18.074 | -165.377100                |
| 6-12 | -194609.800 | -43330.999 | 4.655   | -1.848  | 5.008   | 338-20-50 | 226-07-28  | -42.318 | -196.990290                |
| 6-16 | -194605.145 | -43332.847 | 23.150  | 10.742  | 25.521  | 24-53-32  | 226-32-42  | -33.424 | -773.765600                |
| 6-20 | -194581.995 | -43322.105 | -7.710  | 16.548  | 18.256  | 114-58-54 | 270-05-22  | -6.134  | 47.293140                  |
| 6-9  | -194589.705 | -43305.557 | -11.200 | -5.207  | 12.351  | 204-56-03 | 269-57-09  | 5.207   | -58.318400                 |
| 合計   |             |            |         |         | 115.167 |           | 1800-00-00 | 面積      | -1427.927240<br>713.963620 |

面積計算書

地番: 6-2-2

| 測点  | X           | Y          | DX      | DY      | 距離     | 方向角       | 夾角         | 倍横距     | 倍面積         |
|-----|-------------|------------|---------|---------|--------|-----------|------------|---------|-------------|
| 6-3 | -194606.388 | -43298.968 | 5.483   | -11.796 | 13.008 | 294-55-48 | 270-03-09  | -11.796 | -64.677468  |
| 6-4 | -194600.905 | -43310.764 | 11.200  | 5.207   | 12.351 | 24-56-03  | 270-00-15  | -18.385 | -205.912000 |
| 6-9 | -194589.705 | -43305.557 | -5.482  | 11.783  | 12.996 | 114-57-00 | 270-00-57  | -1.395  | 7.647390    |
| 6-5 | -194595.187 | -43293.774 | -11.201 | -5.194  | 12.347 | 204-52-39 | 269-55-39  | 5.194   | -58.177994  |
| 合計  |             |            |         |         | 50.702 |           | 1080-00-00 |         | -321.120072 |
|     |             |            |         |         |        |           |            | 面積      | 160.560036  |
|     |             |            |         |         |        |           |            | 総計      | 1958.167811 |