

28 街区面積計算書

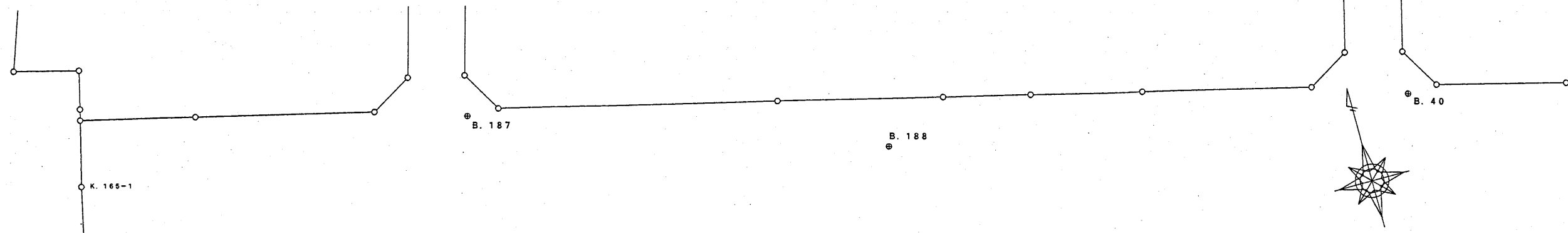

S = 1 : 500

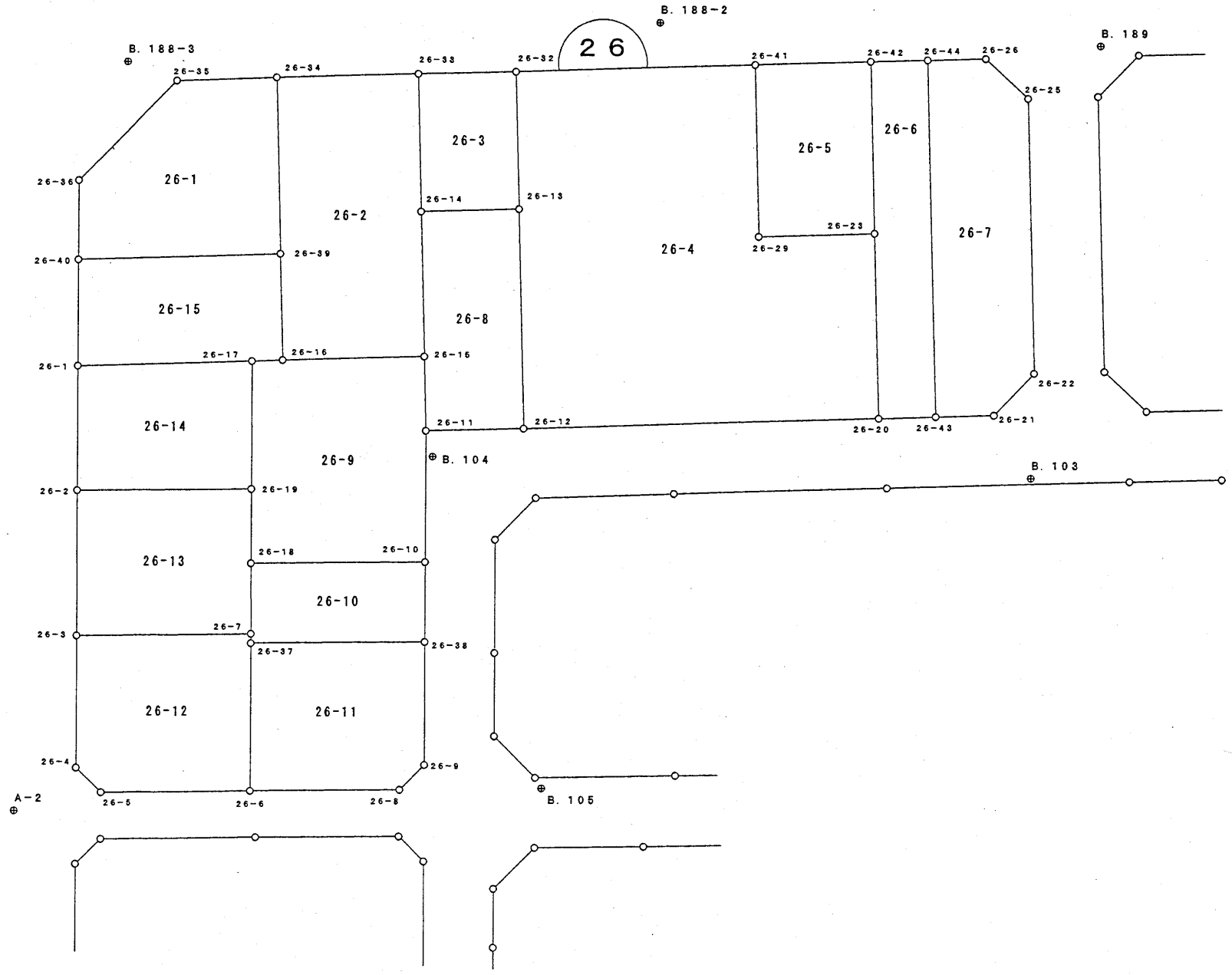
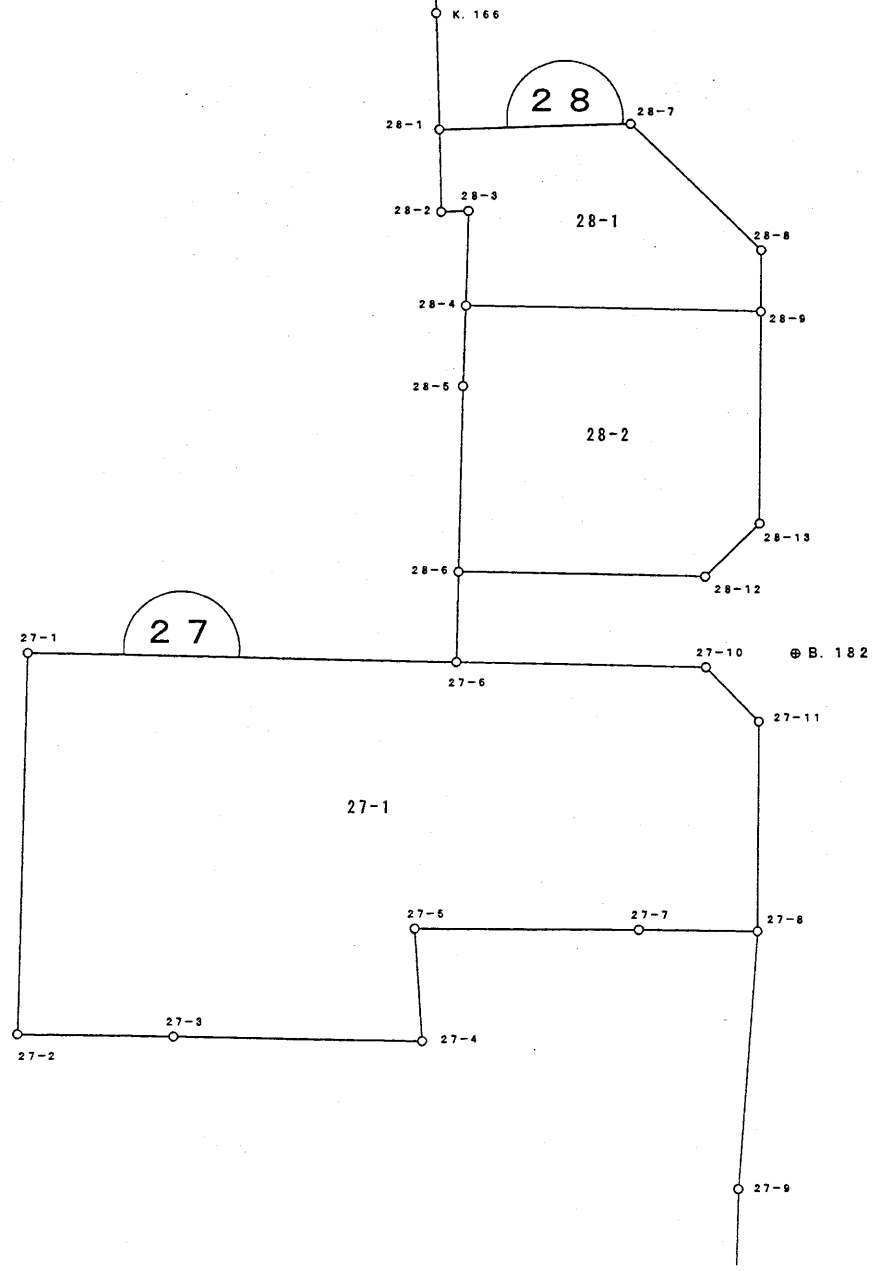

倍横距面積計算書

地番: 28-1

測点	測角	方向角	距離	DX	DY	X	Y	測点	倍横距	倍面積
28-3		196-52-07				-193888.478	-44612.684	28-4		
28-4	89-58-44	106-50-51	19.301	-5.594	18.473	-193894.072	-44594.211	28-9	18.473	-103.337962
28-9	88-48-22	15-39-13	4.047	3.897	1.092	-193890.175	-44593.119	28-8	38.038	148.234086
28-8	134-13-09	329-52-22	11.992	10.372	-6.019	-193879.803	-44599.138	28-7	33.111	343.427292
28-7	134-11-33	284-03-55	12.493	3.036	-12.118	-193876.767	-44611.256	28-1	14.974	45.461064
28-1	90-06-58	194-10-53	5.453	-5.287	-1.336	-193882.054	-44612.592	28-2	1.520	-8.036240
28-2	89-12-24	103-23-17	1.779	-0.412	1.731	-193882.466	-44610.861	28-3	1.915	-0.788980
28-3	273-28-50	196-52-07	6.282	-6.012	-1.823	-193888.478	-44612.684	28-4	1.823	-10.959876
合計	900-00-00		61.347	0.000	0.000			倍面積		413.999384
								面積		206.999692
								坪数		62.617407

倍横距面積計算書

地番: 28-2

測点	測角	方向角	距離	DX	DY	X	Y	測点	倍横距	倍面積
28-5		196-46-46				-193905.296	-44617.810	28-6		
28-6	90-03-49	106-50-35	16.131	-4.674	15.439	-193909.970	-44602.371	28-12	15.439	-72.161886
28-12	134-20-35	61-11-10	4.992	2.406	4.374	-193907.564	-44597.997	28-13	35.252	84.816312
28-13	134-29-19	15-40-29	14.013	13.492	3.786	-193894.072	-44594.211	28-9	43.412	585.714704
28-9	91-10-22	286-50-51	19.301	5.594	-18.473	-193888.478	-44612.684	28-4	28.725	160.687650
28-4	90-29-58	197-20-49	5.313	-5.071	-1.584	-193893.549	-44614.268	28-5	8.668	-43.955428
28-5	179-25-57	196-46-46	12.269	-11.747	-3.542	-193905.296	-44617.810	28-6	3.542	-41.607874
合計	720-00-00		72.019	0.000	0.000			倍面積		673.493478
								面積		336.746739
								坪数		101.865889
								總計		543.746431
								坪数		164.483295